

ROTARY PARK, WONGALING BEACH

CASSOWARY COAST REGIONAL COUNCIL

Landscape Master Plan

PRELIMINARY ISSUE

DATE : 23 MAY 2013

ANDREW PROWSE

LANDSCAPE ARCHITECT

P.O BOX 1419 Cairns QLD 4870
5 Quigley Street, Bungalow,
Australia

t/f 07 40313310
m 0413 278 308
e design@prowse.com.au

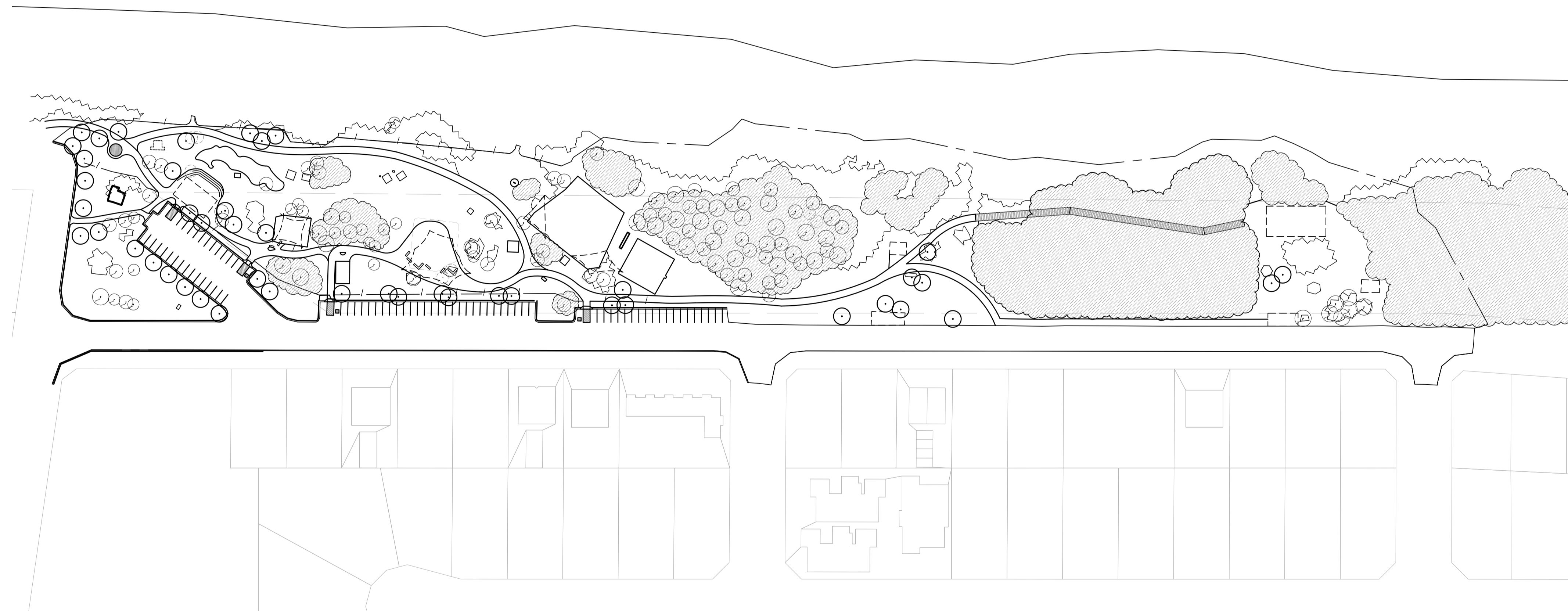
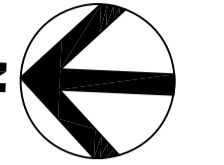

LEGEND

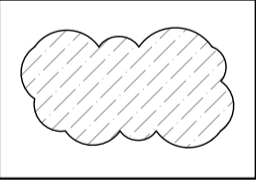
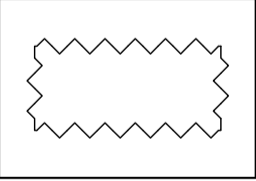
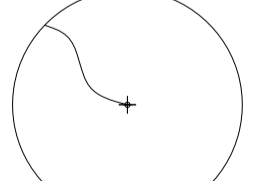
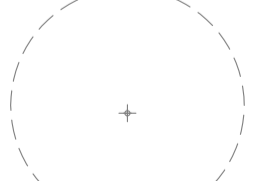
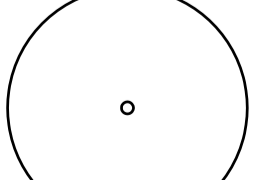
-  EXISTING TREE AREA
-  EXISTING GRASS AREA
-  EXISTING TREES TO REMAIN
-  EXISTING TREES TO BE REMOVED
-  PROPOSED TREES

LOCATION PLAN

PROJECT NAME

ROTARY PARK,
WONGALING BEACH

PROJECT NO.

1092

DRAWING NO.

LP-P1.0

DRAWING NAME

COVER
SHEET

REVISION

-

SCALE

1:1000 @ A1
1:2000 @ A3

DRAWN DESIGN / CHECKED

JT

AP

DRAWN DATE

23/MAY/2013

REVISION HISTORY

REV.	DATE	DESCRIPTION

ISSUE
23.MAY.2013